

- NOTES**
1. INFORMATION CONCERNING THE POSITION OF EXISTING UTILITY INFRASTRUCTURE HAS BEEN EXTRACTED FROM RECORD MAPPING OBTAINED FROM STATUTORY UNDERTAKERS.
 2. ABANDONED SERVICES MAY NOT BE SHOWN ON THIS PLAN.
 3. TRUE POSITION OF THE SERVICES MAY BE DIFFERENT TO THAT SHOWN ON THIS PLAN, WHICH IS INTENDED FOR GENERAL GUIDANCE ONLY. NO GUARANTEE CAN BE GIVEN TO ITS ACCURACY AND IT SHOULD NOT BE RELIED UPON WHEN EXCAVATING IN THE VICINITY.
 4. THESE SERVICES MAY NOT RUN IN A STRAIGHT LINE EITHER HORIZONTALLY OR VERTICALLY BECAUSE OF GROUND CONDITIONS, OBSTACLES AND OTHER REASONS.
 5. BURIED SERVICES MAY EXIST AT VARIOUS DEPTHS AS GROUND LEVEL MAY HAVE BEEN ALTERED SINCE THE UTILITY APPARATUS WAS LAD.
 6. STAND-OFF DISTANCES ARE INDICATIVE ONLY AND ARE SUBJECT TO CHANGE PENDING FURTHER CONSULTATION WITH RELEVANT UTILITY PROVIDERS.
 7. STAND-OFF DISTANCES FROM THE INEOS PIPELINES FOR PILING/BORING ARE THE STARTING DISTANCES. STAND-OFF MAY BE REDUCED DEPENDING ON VIBRATION AND PILING DEPTH SUBJECT TO AGREEMENT WITH INEOS.
- BEFORE EXCAVATING OR GROUND WORKS**
8. ANY SITE INVESTIGATION OR GROUND PENETRATING ACTIVITY SHALL COMPLY WITH THE REQUIREMENTS OF HSE GUIDANCE DOCUMENT 'HS(G) 47 'AVOIDING DANGER FROM UNDERGROUND SERVICES'
 9. ALL UNDERGROUND SERVICES i.e. CABLES, PIPES, DUCTS SHOULD BE LOCATED USING THE FOLLOWING TECHNIQUES:
 - a. REFERENCE TO DETAILED LARGER SCALE DRAWINGS AND CABLE ROUTE PROFILES THESE WILL NEED TO BE REQUESTED FROM THE SERVICE PROVIDER AND REFERRED TO DURING THE DESIGN STAGE AND MADE AVAILABLE ON SITE TO SITE OPERATIVES PRIOR TO THE COMMENCEMENT OF ANY GROUNDWORKS.
 - b. SUITABLE INSTRUMENTS i.e. GROUND PENETRATING RADAR, CABLE LOCATING DEVICES WILL NEED TO BE USED TO DETERMINE THE LOCATION AND PRESENCE OF UNDERGROUND SERVICES/OBSTACLES BEFORE EXCAVATION WORKS PROCEED.
 - c. SAFE DIGGING TECHNIQUES (HAND EXCAVATION) AS DETAILED IN HS(G) 47 WILL BE NECESSARY TO DETERMINE THE EXACT POSITION OF BURIED SERVICES AND OBSTRUCTIONS BEFORE WORK CAN PROCEED.
 - d. ALL APPARATUS FOUND SHOULD BE CROSS REFERENCED WITH THE DETAILED RECORD PLANS RECEIVED FROM SERVICE PROVIDERS. ANY ABNORMALITIES SHOULD BE REPORTED TO THE PROJECT MANAGER.

KEY

[Red line]	SITE BOUNDARY
[Green line]	BRITISH TELECOM
[Blue line]	COMMS - VIRGIN MEDIA
[Yellow line]	INEOS OIL PIPELINE
[Orange line]	GAS - LOW PRESSURE
[Red line]	ELECTRICITY - 11kV
[Orange line]	ELECTRICITY - 11kV x 3
[Red line]	ELECTRICITY - LV
[Blue line]	FOUL SEWER
[Blue line]	SURFACE WATER SEWER
[Blue line]	COMBINED SEWER
[Blue line]	RISING MAIN
[Blue line]	WATER
[Blue line]	WATER - TRUNK MAIN
[Blue line]	WATER - SERVICE MAIN
[Purple shaded area]	INEOS PIPELINE - 25M STAND OFF FOR PILING/BORING
[Purple shaded area]	INEOS PIPELINE - 6M STAND OFF FOR EMBANKMENTS
[Yellow shaded area]	INEOS PIPELINE - 3M STAND OFF FOR MAINTENANCE
[Orange shaded area]	SGN GAS PIPELINES - 3M STAND-OFF FOR MAINTENANCE
[Blue shaded area]	SCOTTISH WATER SEWERS - 3M STAND-OFF FOR MAINTENANCE
[Pink shaded area]	DENOTES DISTRIBUTION OF PEAT
[Red shaded area]	DENOTES DISTRIBUTION OF GLACIOFLUVIAL SANDS AND GRAVELS
[Green shaded area]	DENOTES DISTRIBUTION OF TILL
[Blue shaded area]	DENOTES DISTRIBUTION OF ALLUVIUM AND MADE GROUND
[Black dot]	WS01 DENOTES WINDOW SAMPLER BOREHOLE LOCATION - JANUARY 2017

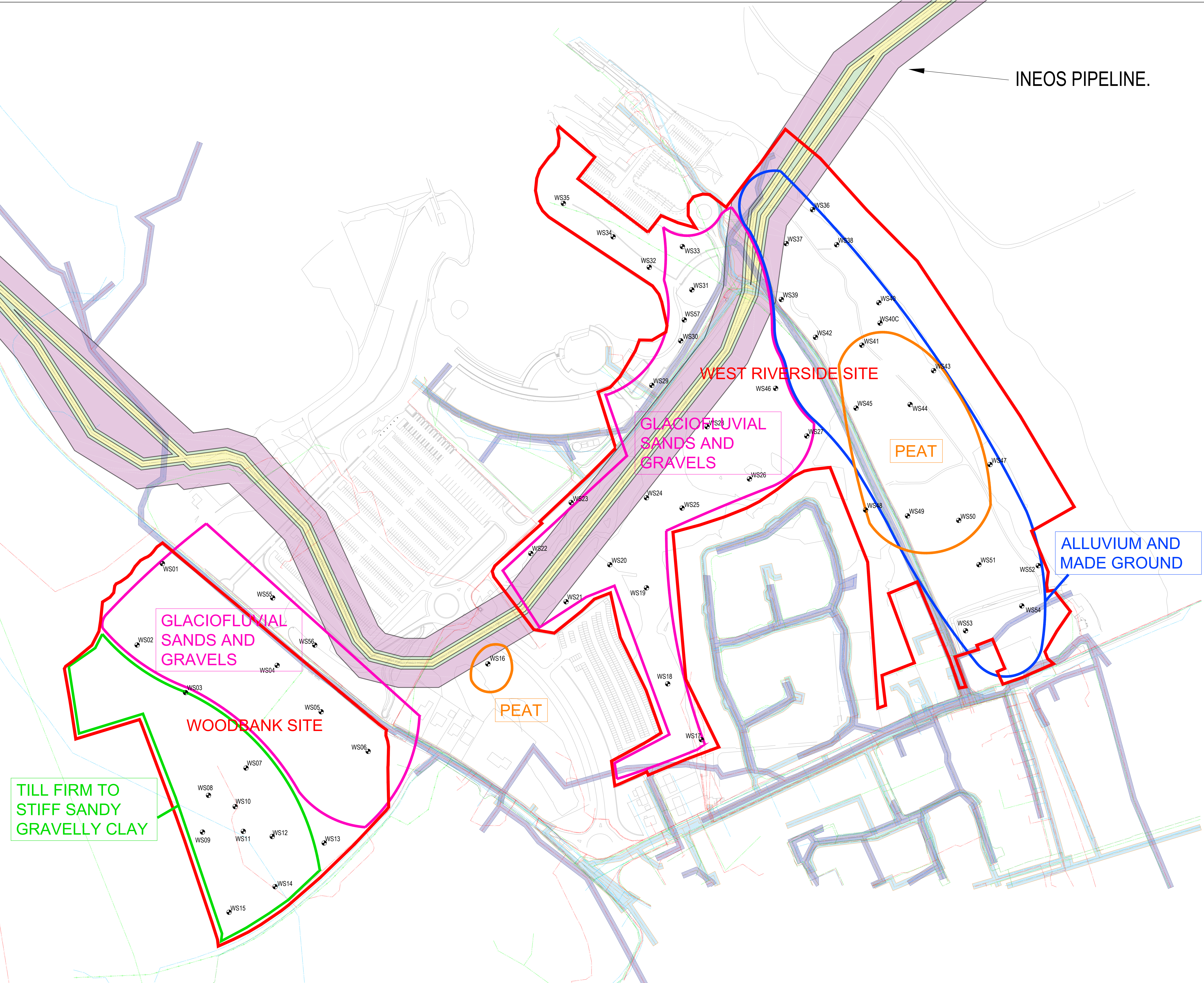

WEST RIVERSIDE LOCH LOMOND
 COMPOSITE PLAN OF SHALLOW GROUND CONDITIONS SHOWING APPROXIMATE DISTRIBUTION OF PEAT, ALLUVIUM, MADE GROUND, GLACIOFLUVIAL DEPOSITS (SANDS AND GRAVELS) AND TILL (GRAVELLY SANDY CLAYS)

		 Offices throughout the UK and Europe www.peterbrett.com © Peter Brett Associates LLP Edinburgh Tel: 0131 297 7010
Date of 1st Issue	Drawn by	
A0 Scale	Checked by	
Figure Number		
	K. EWING	
1:1250	G. SCOTT	
35854/3001-003		

