

No.	Date	Items
A	09.03.22	Redline Boundary Updated
B	29.04.22	Site Boundary updated to solid line
C	04.05.22	North Point Added
D	08.12.22	PPiP boundary line updated
E	05.01.23	Update to key
F	06.01.23	Update to key

Key

- PPiP boundary
- Other land within the control of the applicant subject to development agreement

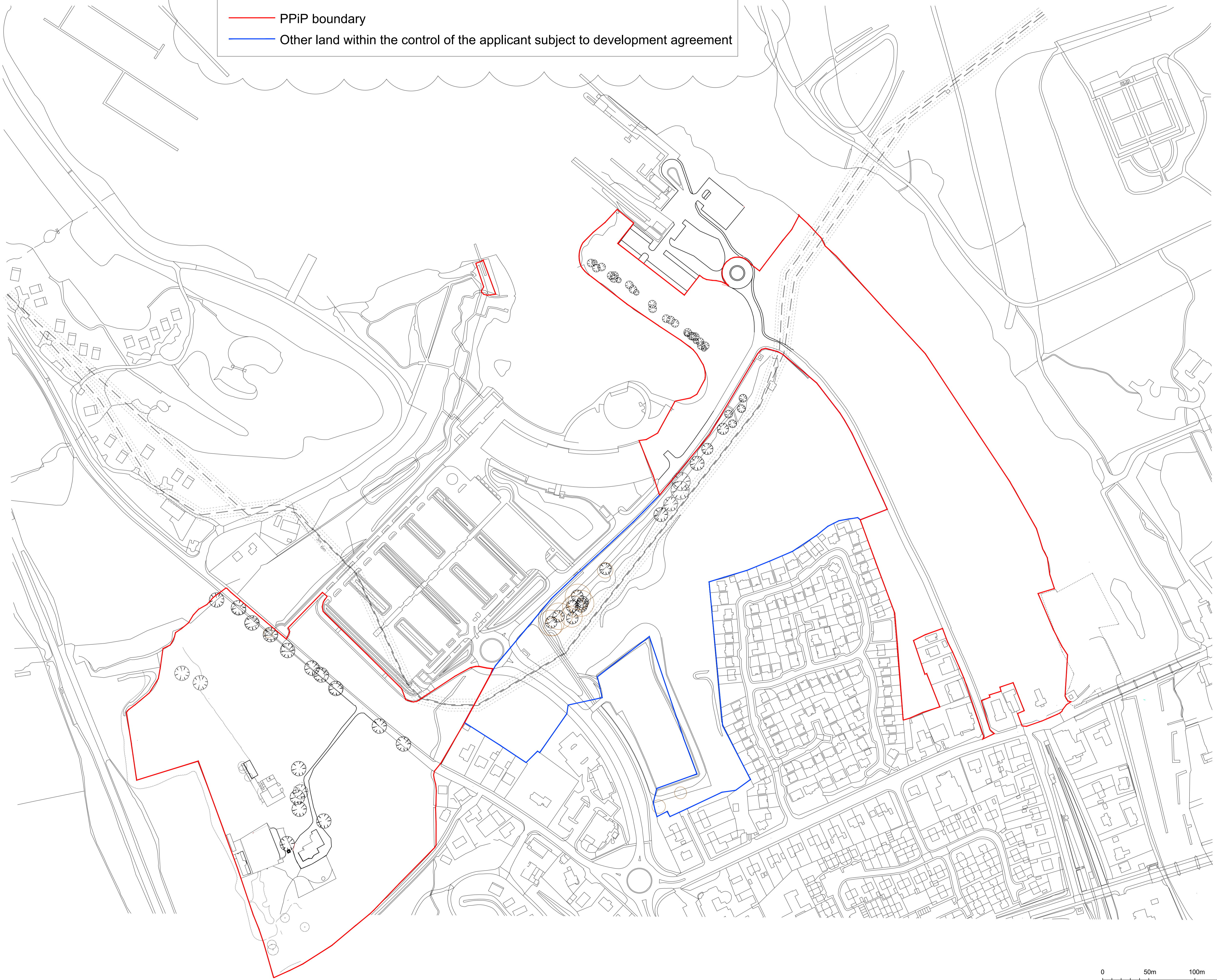

No.	Date	Description	RISK REGISTER

NOTES

DO NOT SCALE
 The Contractor must check & verify all Site & Building Dimensions, Levels & Sward levels at OCR's before commencing work.
 This Drawing must be read with the NBS Contract Specification and any related Structural Engineer or Specialist Contractor Drawings.
COPYRIGHT:
 The information contained on this drawing is the sole copyright of anderson bell + christie & may not be reproduced without express written permission.
 Anderson Bell Christie Architect's License number for copy or display of OS Data is LIG0388.

Lomond Banks
 Flamingo Land
 Site Location Plan

OS No:
ABC-XX-XX-DR-A-0001

Site No:
1363

Scale	Sheet	Scale	Sheet
1:2000	A1		
Drawn	PP	Date	12/09/21
		Checked	RS

anderson bell + christie
 architects

382 Great Western Road
 Glasgow G4 9HT
 T: (+44) 0141 339 1515
 F: (+44) 0141 339 0505
 E: gen@andersonbellchristie.com
 W: www.andersonbellchristie.com

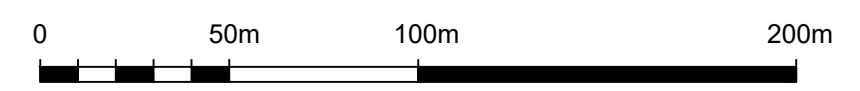
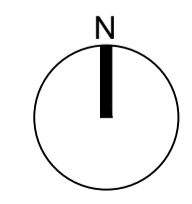

When printing from PDF this line should measure 50mm